

# Try the New Look of Infinite Campus

Last Modified on 10/22/2022 10:45 am CDT

Infinite Campus has a new look and feel! All Campus Cloud and Cloud Choice customers can now toggle a switch to replace their existing Infinite Campus with a new UI and navigational structure. This new Infinite Campus experience contains all of the same tools as the current Infinite Campus but includes several improvements.

## Improvements include:

- [A simplified navigation structure](#)
- [Responsive UI design](#)
- [A user-created menu of favorite tools](#)
- [Quick access to recently used tools](#)
- [Intuitive related tools toolbar](#)
- [Navigable breadcrumbs](#)
- [Robust in-tool person search](#)
- [A unified search menu for quickly searching a multitude of data](#)
- [A useful student information card](#)

## Questions? Concerns?

- [Why is Infinite Campus Making this Change?](#)
- [How Do I Turn it On?](#)
- [Where Did My Campus Instruction Tools Go?](#)
- [Help! I Can't Find a Tool](#)
- [If I Change My Mind, Can I Turn This Off?](#)
- [How Do I Get Back to the Old Infinite Campus?](#)
- [Can I Control Where My Custom Tools/Reports Appear?](#)
- [How Do I Provide Feedback?](#)
- [What is the Current Timeline for the New Look of Campus?](#)
- [List of Tool Locations in New Look of Campus](#)

The new look and feel of Infinite Campus is available for District Edition Campus Cloud, Cloud Choice, and In-District hosted customers.



Some Premium Product functionality may not yet be available within the new UI.

# Simplified Navigation

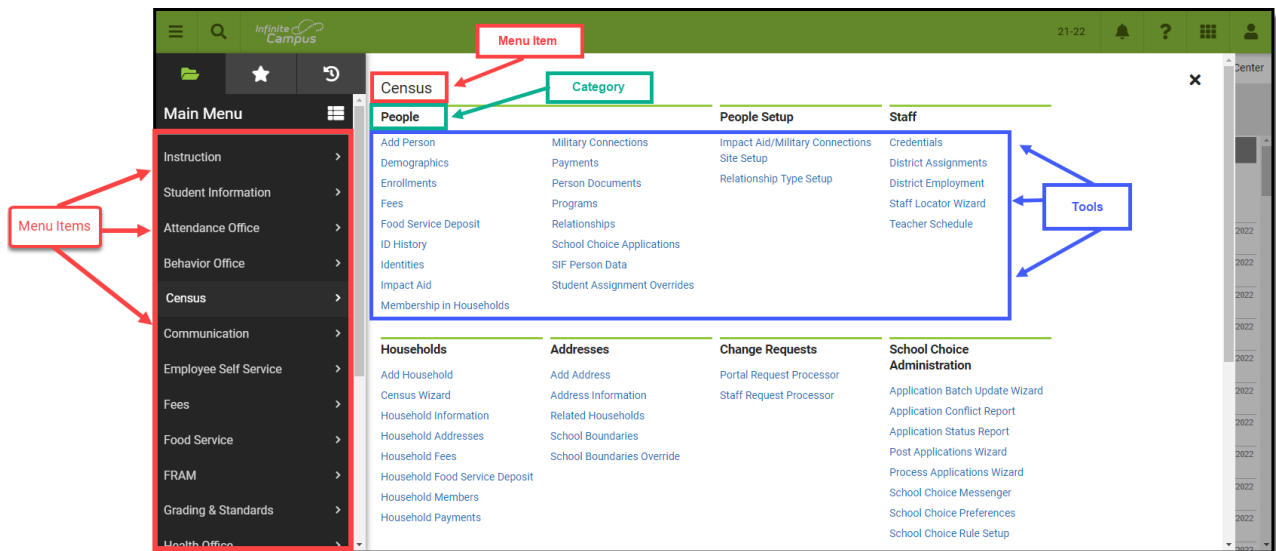
Navigation is greatly simplified in the new look of Infinite Campus. Gone are the days of row after row of tabs, tools buried below multiple other tools in the Campus outline, and the frustration of not knowing where to look for a particular set of tools. With the new Infinite Campus interface, all tools within a menu item (i.e., Instruction, Student Information, Behavior) are displayed on a single screen, organized by category. You can quickly and easily see all tools available and understand tool relationships based on their category.



The new Infinite Campus also remembers the last tool you selected, meaning navigating back to the last tool you were working in is as easy as hitting the back button on your browser. Infinite Campus will even retain the student you are currently working on.

For users who access a small number of tools or who prefer a navigation style similar to Classic Campus, you can toggle the Main Menu to display and list tools in a flat, organized list of tools per menu item by clicking the  icon. You can then return to the new navigation style at anytime by clicking the  button.

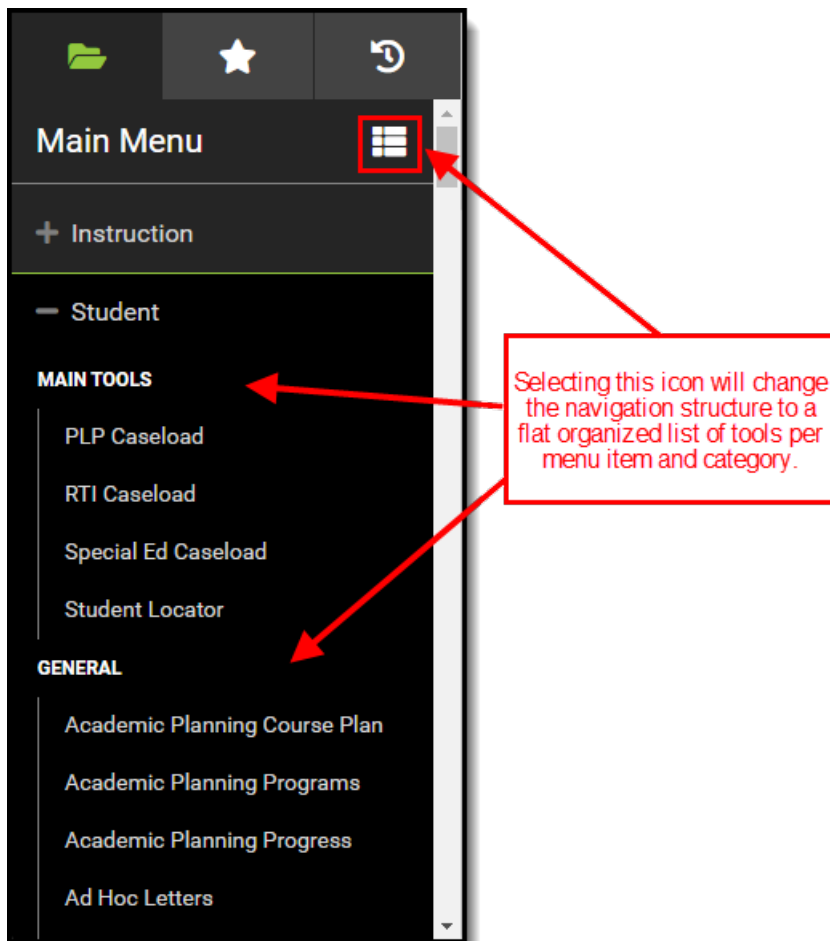

## Responsive UI Design

The New Look of Infinite Campus is designed with a responsive UI. This means no matter the size of the screen or device, you will still have access to the same functionality and tooling.

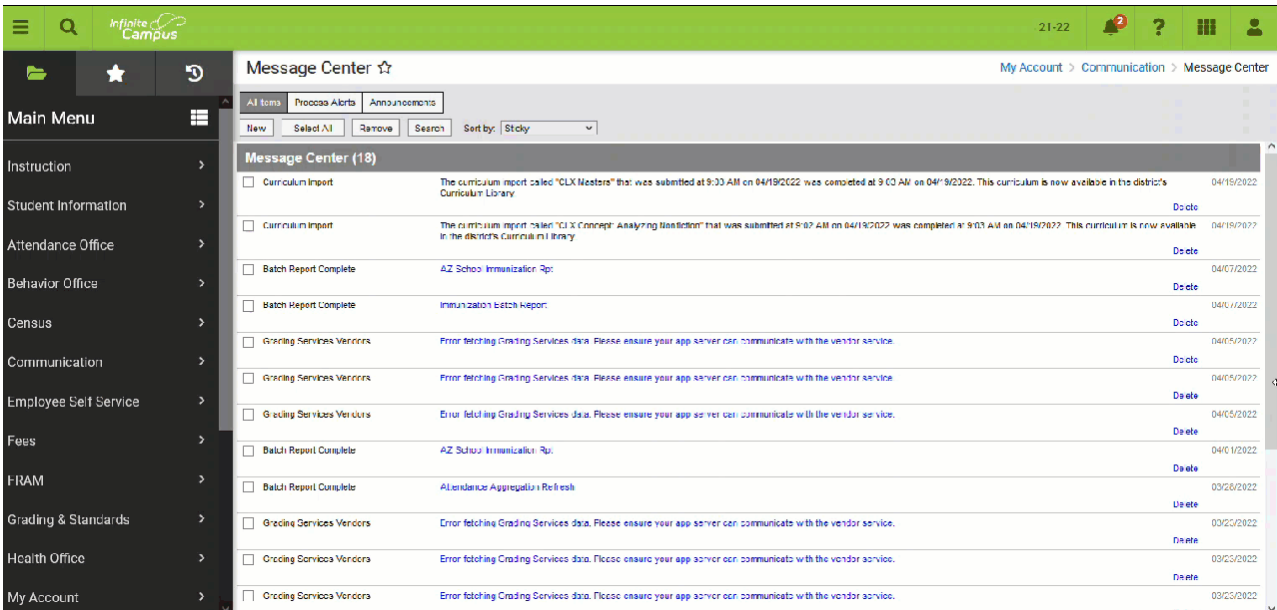

As the screen gets smaller, the banner shrinks along with it until it becomes a series of icons.

For usability on smaller screens such as a phone, the Main Menu becomes a flat list of tools.

Related Tools are not available on small screens.

On smaller screens, flags are visible by selecting the icon (see image below).

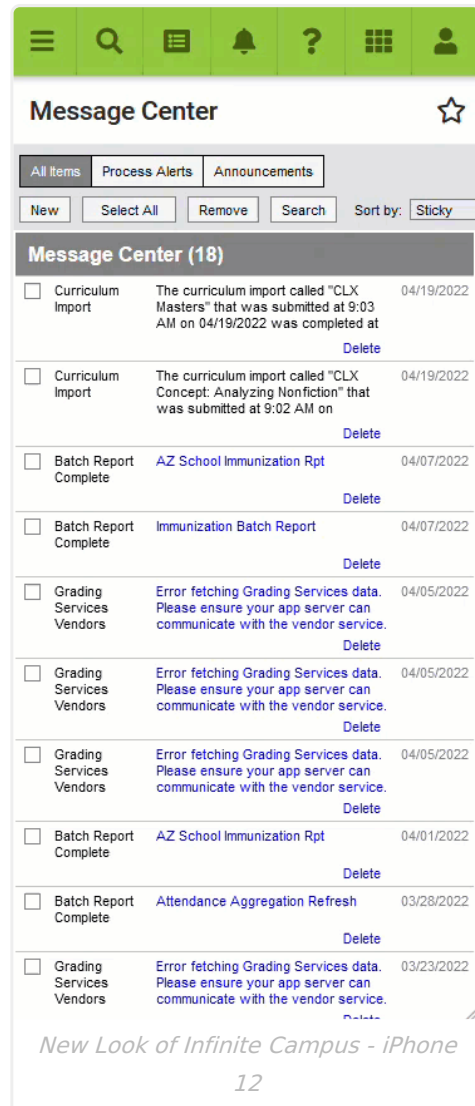
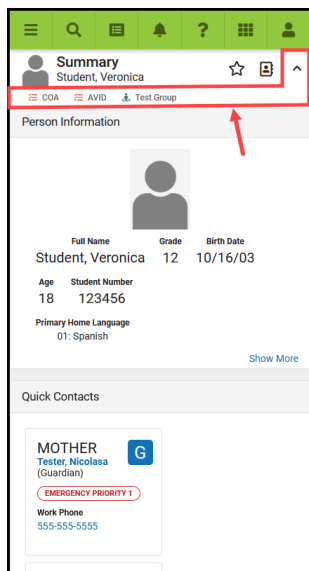

# User-Created Menu of Favorite Tools

You can now mark tools as favorites and have these tools populate a separate menu. This allows for easy access to those tools which you find most important and use on a day-to-day basis. To add a tool to your favorites menu, select the ☆ next to the tool name. To edit the order of this menu, click the **Edit** button.

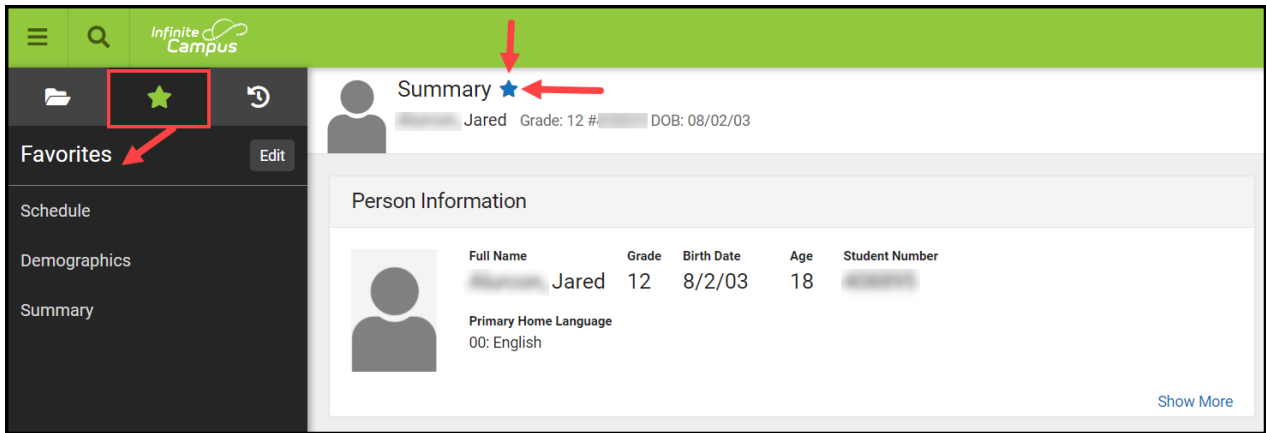

# Quick Access to Recently Used Tools

You can also quickly access a menu of recently visited tools by clicking the  icon. This speeds up the process of jumping back and forth between different tools when working through various workflows.

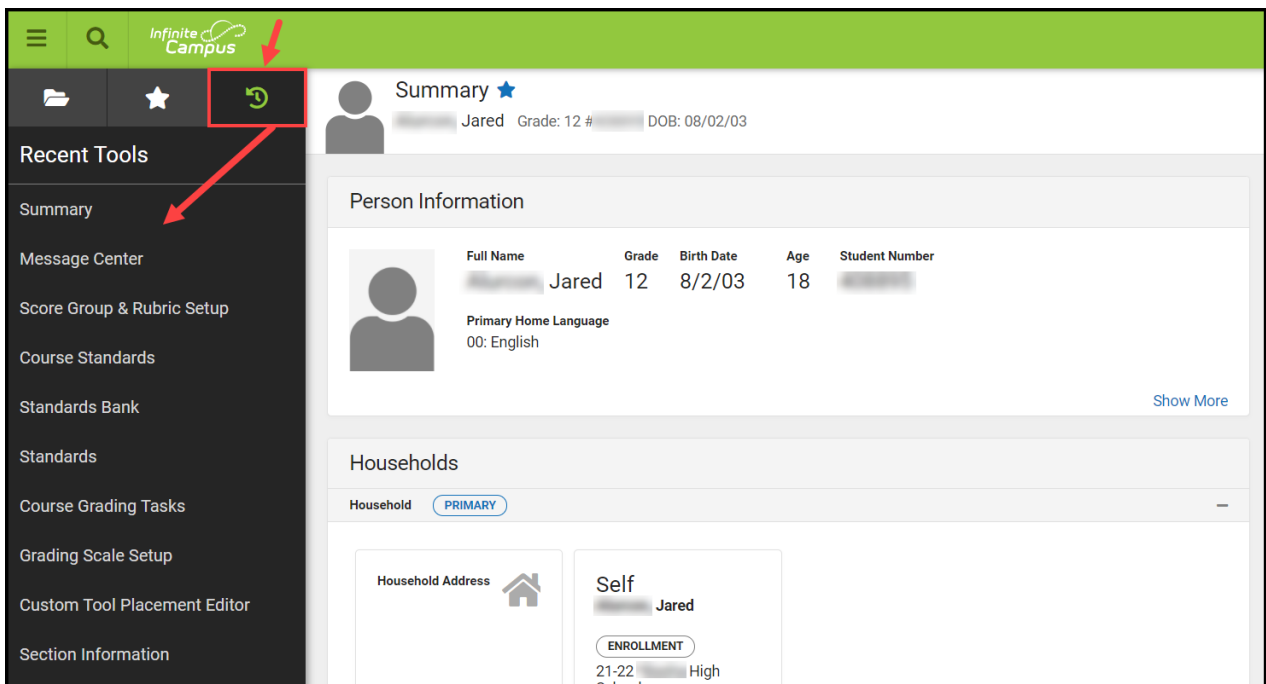

# Intuitive Related Tools Toolbar

Many tools throughout the New Look of Infinite Campus provide a Related Tools toolbar on the right-hand side of the screen. This toolbar functions much like how tabs worked in Classic Campus, allowing you to visually see what tools are related to each other and easily navigate to these tools to fill out related data.

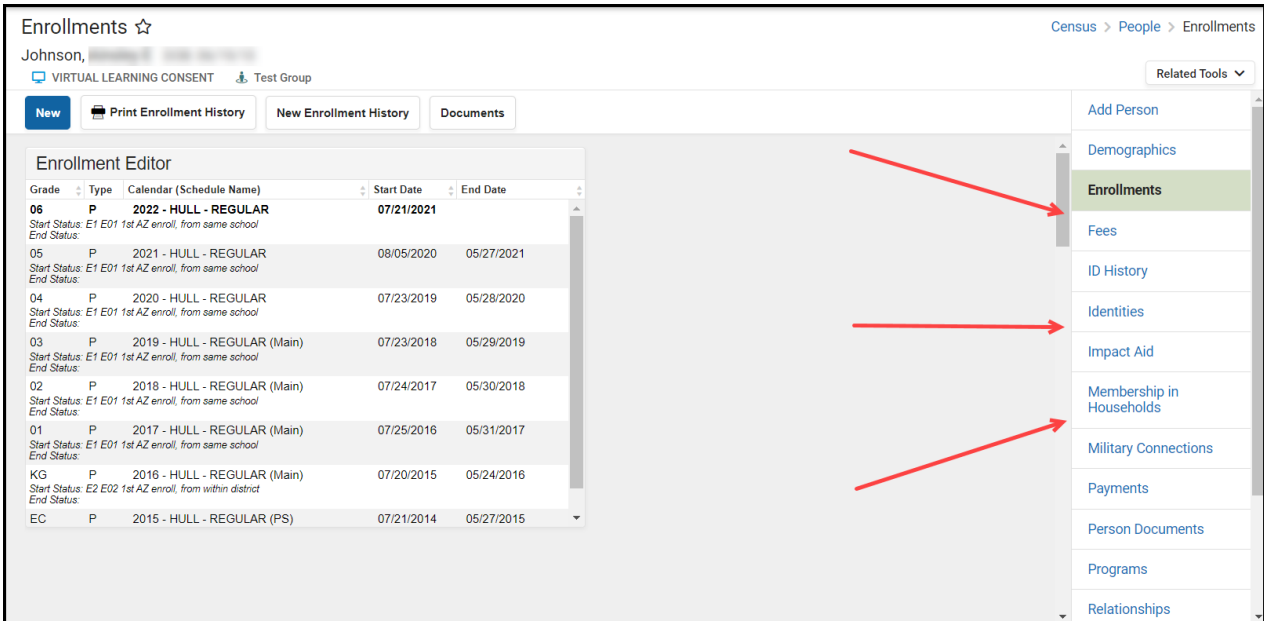

Another useful aspect of the toolbar is its ability to remember the context of what you are working on. For example, if you are filling out a student's enrollment record, navigating to Demographics automatically goes into that student's Demographics record without the need to search for and select the student again.

## Navigable Breadcrumbs

Navigable breadcrumbs are provided on the right-hand side of the screen when working within a tool. Clicking an item in the breadcrumb will send you to the category or menu item selected.

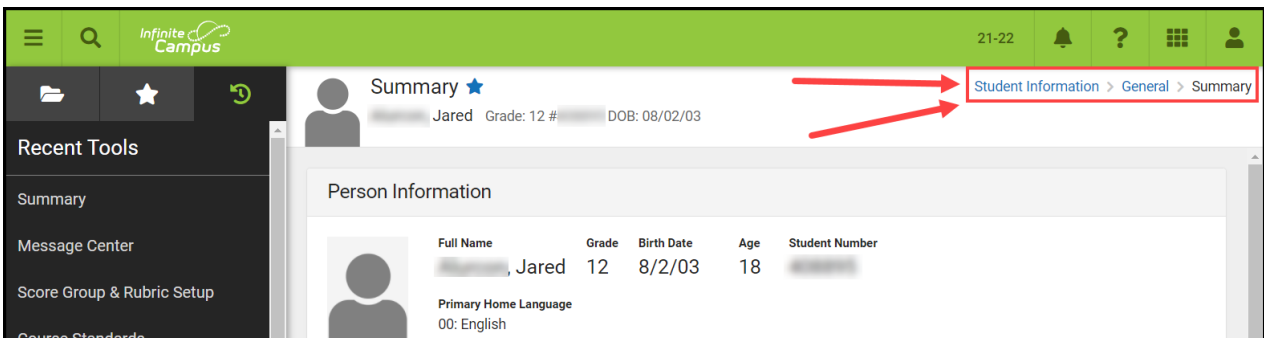

## Robust In-Tool Person Search

When selecting a tool which requires a person be selected, a robust person search prompt is provided, allowing you to search for the person using a variety of options.

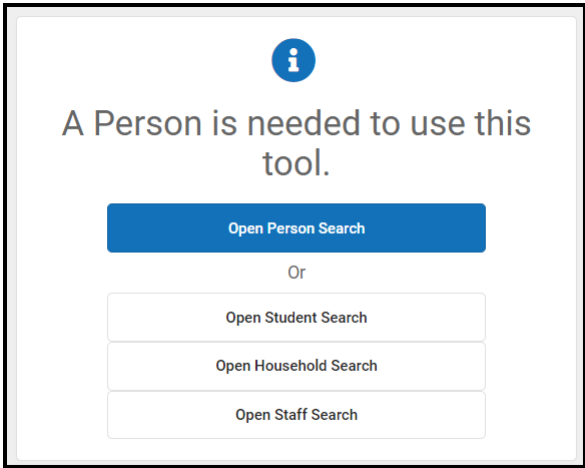

## Unified Search Menu

The search menu allows you to quickly and easily search a multitude of data within Infinite

Campus. Simply click the magnifying glass icon , select the type of data you wish to search (i.e., Student, Household, Tool, etc), and enter your search criteria. Results will appear below the search box.

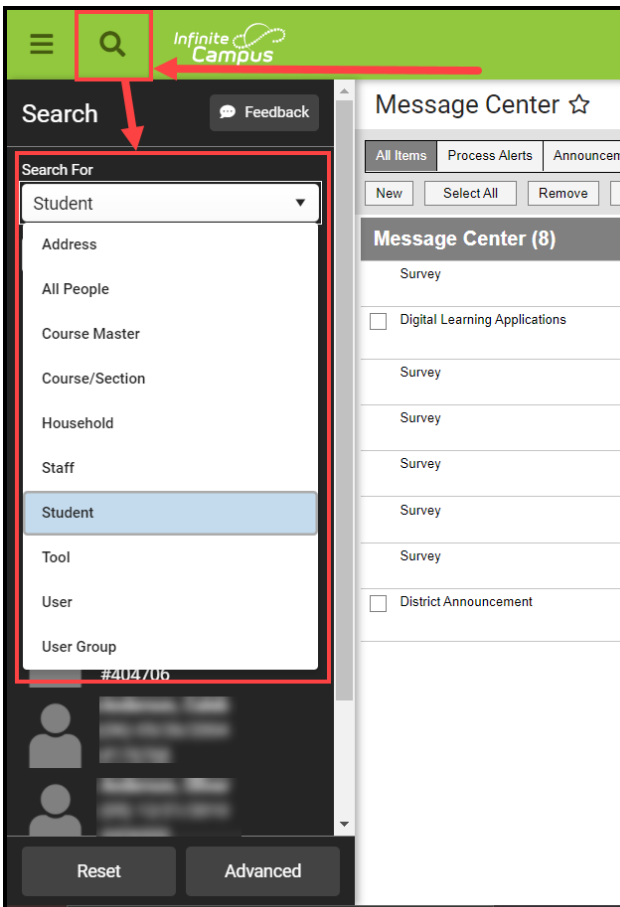

Selecting a search result will send you to the appropriate tool for that piece information.

**Search**

Search For: Student

abegg

- Abegg, Justin (08) 01/01/2008 #1101900001
- Abegg, Robert (KG) 10/01/2015 #161900005
- Abegg, Stella (05) 08/13/2010 #161000001
- Abegg, Dylan (11) 09/15/2004 #171900001**
- Abegg, Emma (01) 09/30/2014 #181000001
- Abegg, Wallace (11) 05/15/2004 #181900002
- Abegg, Colton (KG) 02/01/2016 #1102667

**Summary**

Abegg, Dylan Grade: 11 #171900001 DOB: 09/15/04

Medical Condition(s) NHS Computer Science Pathway

**Person Information**

Full Name	Grade	Birth Date	Age	Student Number
Abegg, Dylan Victor	11	9/15/04	17	171900001

Cell Phone: (763)555-0175 Email: StudentOne@infinitecampus.com Primary Home Language: 045: Spanish

**Households**

Abegg PRIMARY

Phone	Household Address	Father	Step Parent	Self
(763)555-0199	4321 109th Ave NE, Blaine, AZ 55449	Abegg, Donald L (Guardian) EMERGENCY PRIORITY 1	Abegg, Millie (Guardian) EMERGENCY PRIORITY 2	Abegg, Dylan Victor ENROLLMENT 21-22 Harrison High Grade

**Quick Contacts**

**Father** Abegg, Donald L (Guardian) EMERGENCY PRIORITY 1 Cell Phone: (763)555-0198

**Step Parent** Abegg, Millie (Guardian) EMERGENCY PRIORITY 2 Cell Phone: (763)555-0197

The search menu also remembers your last search results, allowing you to quickly toggle back and forth between the list of tools within the Main Menu and search results without losing your place in either screen. Search results also remain visible within the left-hand panel while you interact within a tool you got to by selecting a search result.

**For a visual demonstration of how this search works, watch the video below.**



## Advanced Search

Advanced search functionality in the New Look of Infinite Campus functions the same as it does in Classic Campus. To do an advanced search, click the magnifying glass icon, select the search context, and click the **Advanced** button (see image below).

For more information about this feature, see the [Searching in Campus](#) article.

Note: Some search contexts do not have advanced search functionality.

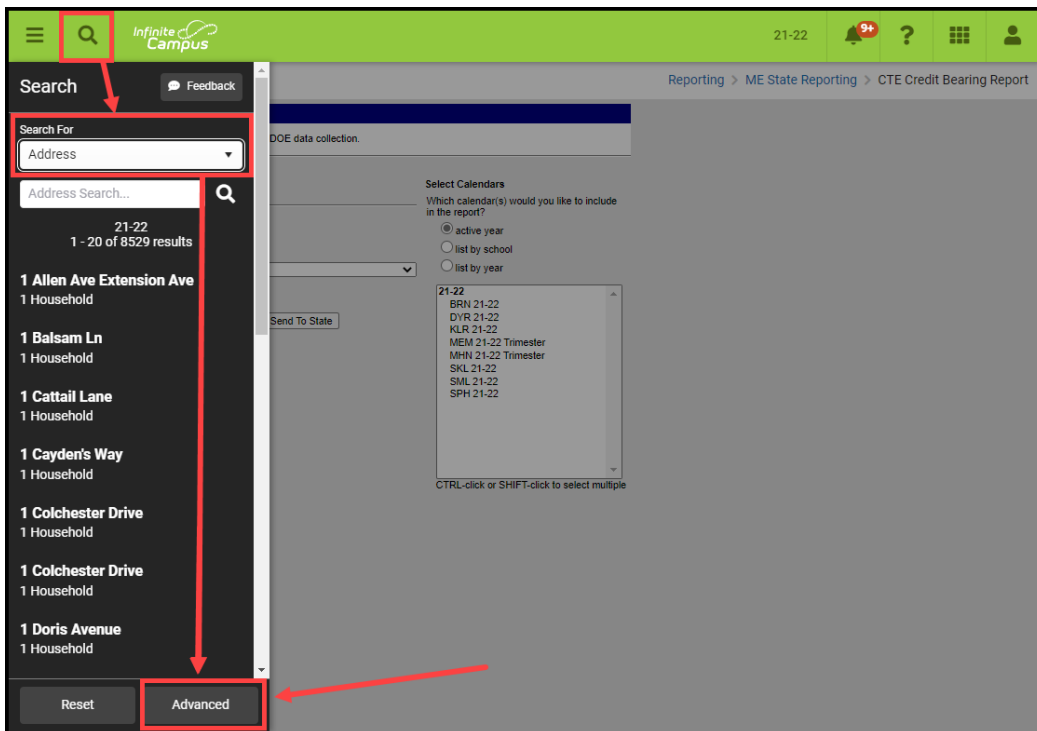

## Where Did the Search Bar Go? What About Right-Side Search Results?

▶ [Click here to expand...](#)

We would love to hear any feedback you might have! You can do so by clicking the Feedback icon near the top of the search tool (see image below).

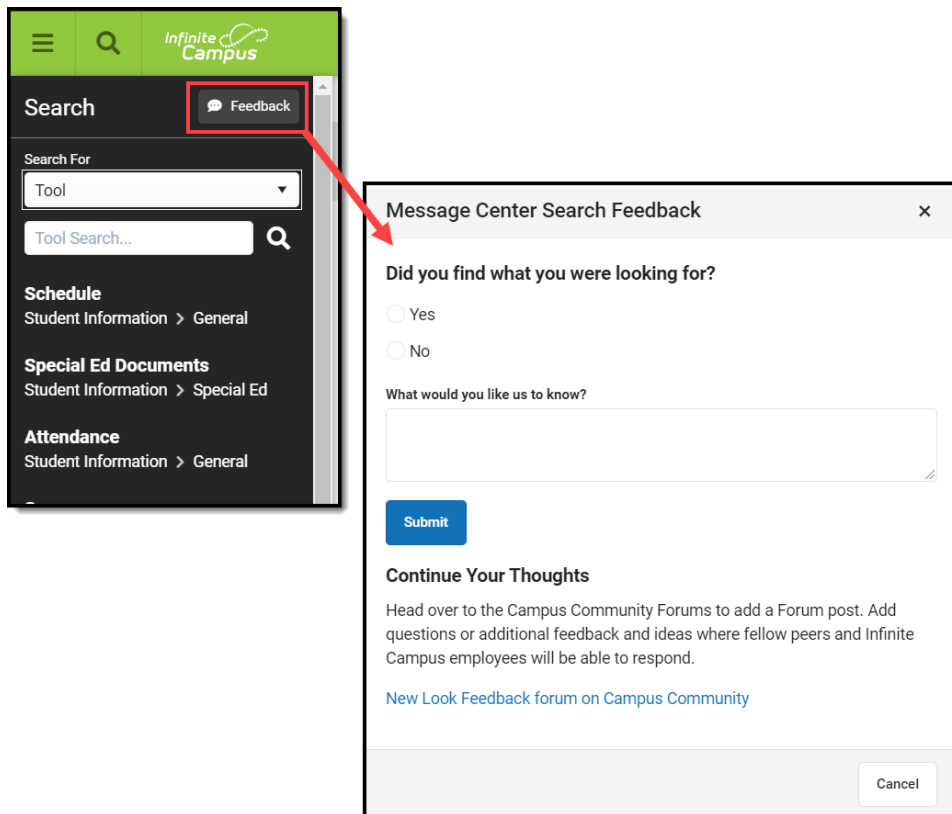

## Student Information Card

Tools focused on a specific student now contain a useful information card which when selected, details important student information as well a summary of their enrollment record(s) in the active school year. This is especially useful for reviewing enrollment information without the need to navigate away from the tool you are currently working in.

**Attendance** ☆

Student, John M  Grade: 01 #851241 DOB: 12/15/14 Counselor: Christy Tester

Medical Condition(s) Immersion Virtual

New Period Detail Daily Detail Documents

Term Q2 09/03/2021 - 01/21/2022 Instructional Days: 81 Present Days: 81

Unknown Excused Unexcused Exempt

Period AM PM ART MUS PE

Absent	0	0	0	0	0
Early Release	0	0	0	0	0
Tardy	0	0	0	0	0

Term Instructional Days

Period	AM	PM	ART	MUS	PE
Absent	0	0	0	0	0
Early Release	0	0	0	0	0
Tardy	0	0	0	0	0

**Information Card**

Student, John M

Grade Student # DOB  
01 851241 12/15/14

Counselor  
Christy Tester

2021-22 Enrollment

**Robbinsdale Spanish Immersion**

Start Date	End Date	Homeroom
09/08/2021	06/10/2022	0007 Christy Tester

**Robbinsdale ESY Program** INACTIVE

Start Date	End Date	Homeroom
07/12/2021	07/30/2021	

Close

The student information card is also useful for viewing information no longer shown in the banner because you are using a device with a small screen.

**Behavior** ☆ 

Student, Laura d

Print Current Calendar Print All Years

Behavior Management Detention

Outstanding Detention Time: 0  
Total Suspension Days for selected Year: 0.00  
Total Suspension Days for selected Calendar: 0

Behavior

## Why is Infinite Campus Making this

# Change?

We want our users to have a positive experience when using our product. When first logging in, it should be easy to find the tools and data you need to complete your job. We believe these new changes will help to improve your experience and make your job easier.

As a living software system, Infinite Campus doesn't update to a new version quite like other programs do. We release new features and software changes every 4 weeks with our continuous release cycle. This UI change is much bigger than a standard update as it touches all areas of the product and has been years in the making. We're doing a lot of front end changes for our users, as well as behind the scenes changes to bring our product to a new technological platform that keeps our student information system viable into the future.

The new navigation provides a way to modernize our tech stack and show old and new tools side-by-side while supplying a modern platform for new tools in the future. This change allows us to continue to protect our investment in legacy tools while providing the latest features.

# How Do I Turn it On?

To turn on the new look of Infinite Campus:

1. Select the User Menu icon (the person icon  in the upper right-hand corner of the screen).
2. Click the **Try New Look** toggle from OFF to ON (see image below).

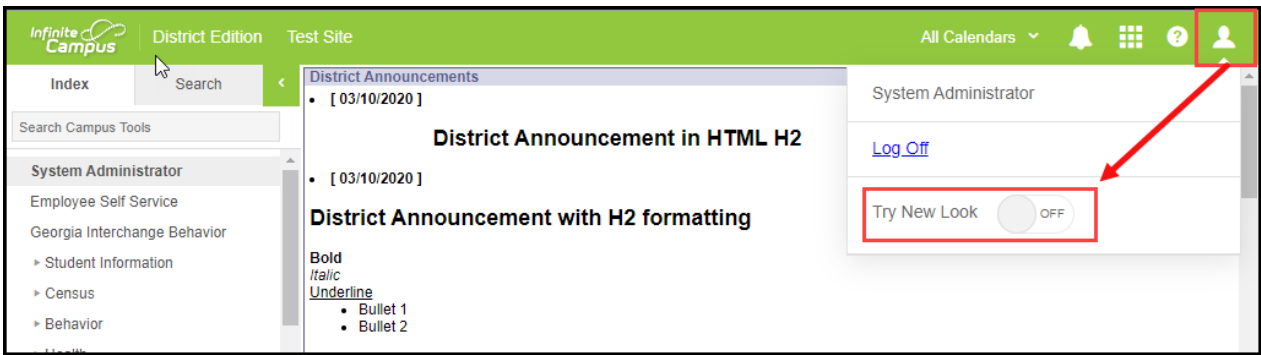

The new look of Infinite Campus is only available for District Edition Campus Cloud and Cloud Choice customers.

If the Try New Look button does not appear for you, it is not currently available in your instance of Infinite Campus or your District Administrator has turned off this feature.

For District Administrators, a system preference exists which allows you to control who can access the Try New Look toggle or hide the toggle altogether. This preference can be accessed by searching for [District Preferences](#) and locating the User Access to the New Look of Campus

preference (see image below).

By default, this preference is set to 'All Users' for all Campus Cloud and Cloud Choice customers. For In-District and Self-Hosted Customers, this preference is not visible as the Try New Look UI is currently not available for these hosting models.

## Where Did My Campus Instruction Tools Go?

All Campus Instruction tools are available by selecting the **Instruction** menu item (see image below). The new look and feel of Infinite Campus rejoins Campus Instruction with the rest of the Campus tools and removes the need to use two separate spaces of Infinite Campus to do your work.

This change modifies how you navigate to Campus Instruction tools but DOES NOT impact their functionality.



# Help! I Can't Find a Tool

We understand one of the most challenging aspects of the new navigation is finding where tools are now located. To ease this burden, we highly suggest you take advantage of the Tool search located within the unified search found by selecting the magnifying glass icon  .

[Click here to access a list of where tools are now located in the New Look of Campus.](#)

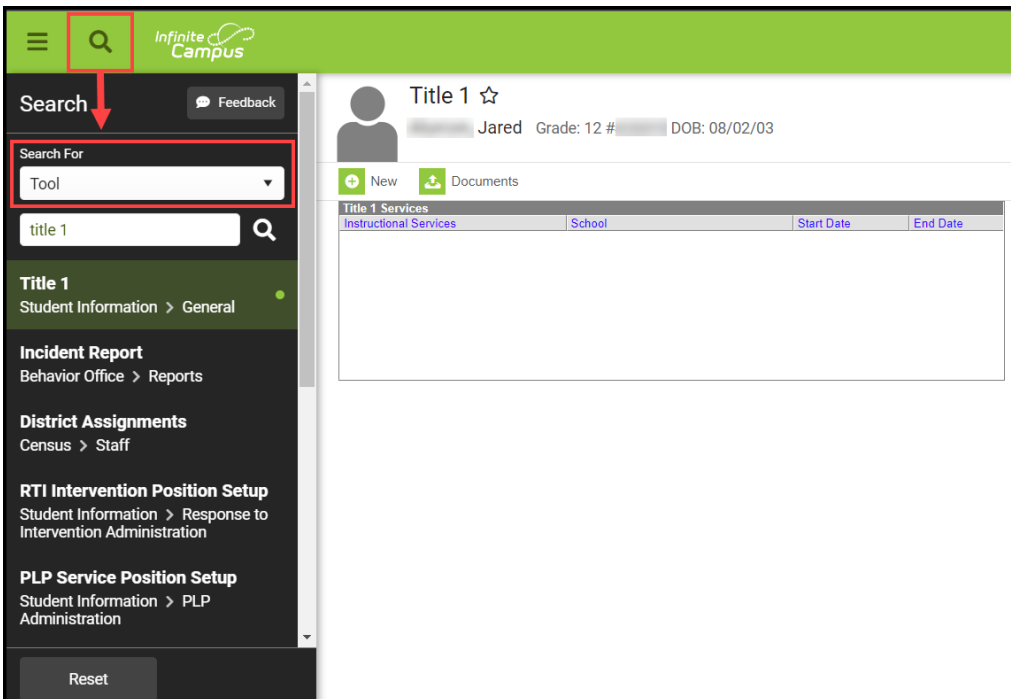

You can also find tools quickly and easily by creating your own list of favorites. See the [User-Created Menu of Favorite Tools](#) section for more information about this process.

## If I Change My Mind, Can I Turn This Off?

If at any time you change your mind and decide you would like to return to the classic view of Infinite Campus, select the person icon  in the upper right-hand corner of the screen and click the **Try New Look** toggle to OFF. The screen will refresh and you will return to the classic view of Infinite Campus.

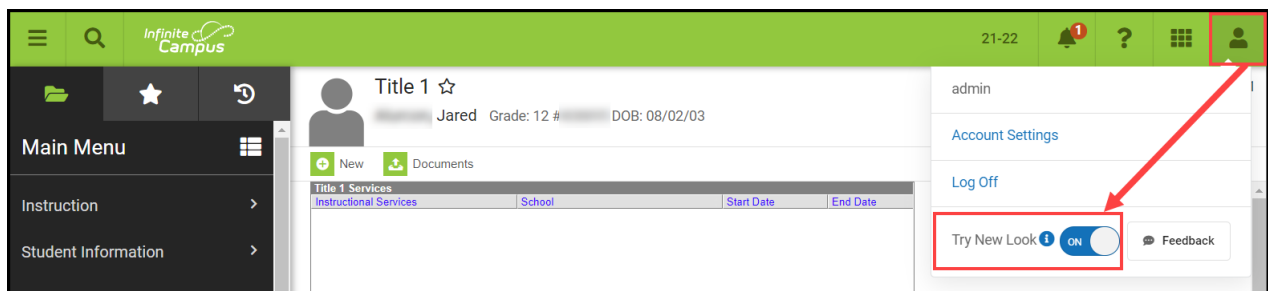

## How Do I Get Back to the Old Infinite Campus?

To return to the classic view of Infinite Campus, select the person icon  in the upper right-hand corner of the screen and click the **Try New Look** toggle to OFF (see image above). The screen will refresh and you will return to the classic view of Infinite Campus.

## Can I Control Where My Custom Tools/Reports Appear?

Yes! Using the [Custom Tool Placement Editor](#), you can customize where in the New Look and Feel of Campus navigation UI your custom tools/reports will live. You can either place custom tools/reports within existing menu items and categories or customize and create your own menu items and categories.

**Custom Tool Placement Editor** ☆

System Settings > Custom Data and Links > Custom Tool Placement Editor

### Custom Tool Placement

This tool allows you to determine where in the navigation your custom tools should live. You can structure and organize custom tools by creating new menu items, new categories, and moving tools throughout the navigation structure.

#### Custom Tool Mappings

**New Menu Item** – This allows you to create a new item which appears in the Main Menu on the left-hand side of the screen. A menu item will not appear in the UI until at least one category with at least one tool is assigned to it.

**New Category** – Categories allow you to organize tools within menu items, whether that be adding a new category to an existing core menu item or a custom menu item. A category will not appear in the UI until at least one tool is assigned to it.

**New Tool Mapping** – This is how you indicate the placement of a tool within the navigation structure (define the tool's menu item and category).

### Navigation Tree

Search Campus Tools

- ▶ Instruction
- ▶ Student Information
- ▶ Attendance Office
- ▶ Behavior Office
- ▶ Census
- ▶ Communication
- ▶ Data Integrity Tools
- ▶ Employee Self Service

New Menu Item    New Category    New Tool Mapping

## What is the Current Timeline for the New Look of Campus?

Enhancements and features continue to be added to the New Look and Feel of Infinite Campus as it remains in Open Beta through the 2022-2023 school year.

These features include:

- A unified search menu for a quick and easy way to search a multitude of different data within Infinite Campus
- An intuitive related tools toolbar
- A useful Student Information Card, allowing you to view important details about a student without the need to navigate away from the tool you are currently working within
- Improvements to search performance
- The inclusion of FRAM tools

We also now allow districts utilizing our In-District hosting model to access and use the New Look



and Feel of Infinite Campus.

Although significant progress has been made, we have several important milestones we need to complete such as inclusion of all advance search contexts, providing self-hosted customer participation, and focusing on State Edition and Student/Parent Portals before we can move past an open beta status.

Once we are ready to make the New Look and Feel of Infinite Campus the default navigation, our plan is to keep Classic Campus available for an additional school year.

We appreciate the multitude of positive and constructive feedback you have all provided us via our forums, in-product feedback, and various user group/training engagements. We will continue to listen to this feedback and work hard to provide the best experience and functionality possible.

## Give Us Feedback!

We would love to hear any and all feedback you may have about the new look and feel of Infinite Campus. To submit feedback, select the person icon in the upper right-hand corner of the screen and click **Feedback**.

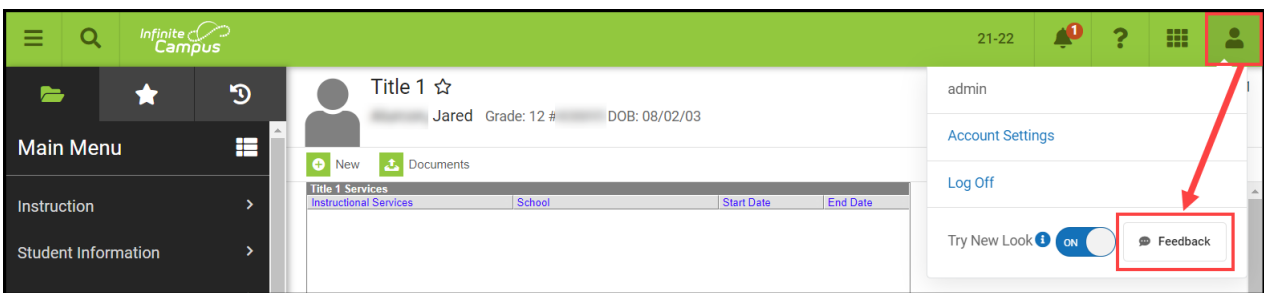

## List of Tool Locations in New Look of Campus

The spreadsheet below provides a list of where tools now exist in the New Look of Campus UI as well as which tools were deprecated and those which have not yet been added.

- [Campus.2239 Tool Mapping.xlsx](#)
- [Campus.2235 Tool Mapping.xlsx](#)
- [Campus.2231 Tool Mapping.xlsx](#)
- [Campus.2227 Tool Mapping.xlsx](#)
- [Campus.2223 Tool Mapping.xlsx](#)
- [Campus.2219 Tool Mapping.xlsx](#)
- [Campus.2215 Tool Mapping.xlsx](#)
- [Campus.2211 Tool Mapping.xlsx](#)
- [Campus.2207 Tool Mapping.xlsx](#)
- [Campus.2203 Tool Mapping.xlsx](#)

### Campus Tool Mappings .2040 - .2152

▶ [Click here to expand...](#)

This list does not contain custom tools created by your district and/or Infinite Campus.

---