

# Settings (School Store)

**Classic View:** School Store > Administration > Settings

**Search Terms:** Settings

The Settings tool allows you to choose where you want the School Store to display and set up different options for every store. From here you can also set up [Public Store](#) options. The Public Store is a website where anyone can shop for goods or services from your district.

## What can I do?

- [Create a School Store](#)
- [Create a Public Store](#)

## Create a School Store

Create a store for each school by selecting the school in the Campus toolbar. Use the field descriptions provided here to complete the screen then click **Save**. Repeat this procedure for each school that is going to have a school store.

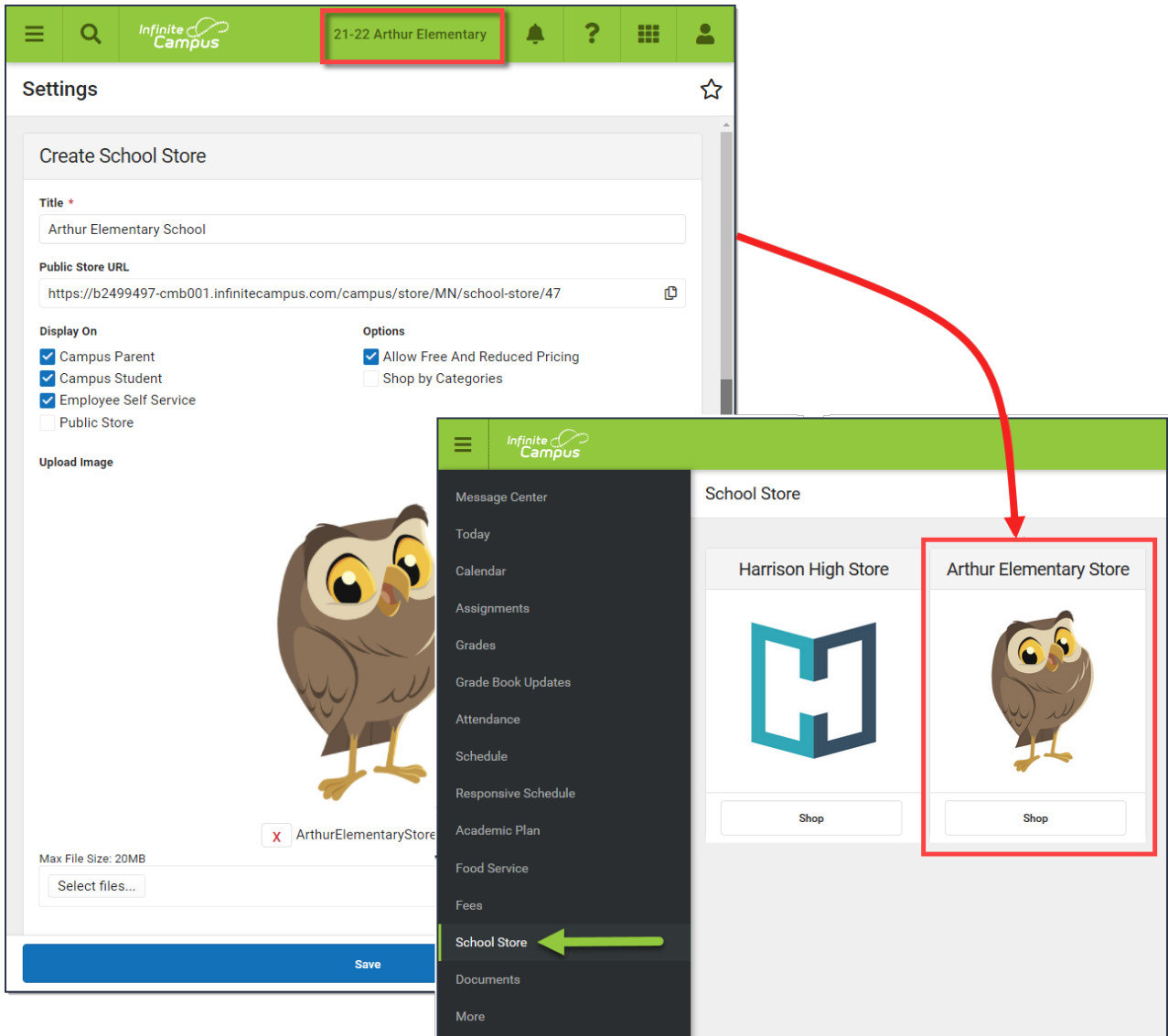

## Field Descriptions (School Store)

Field	Description
<b>Title</b>	The name of the store.
<b>Display On</b>	You can display the store in <b>Campus Parent</b> , <b>Campus Student</b> , <b>Employee Self Service</b> or the <b>Public Store</b> . If you do not want the store to display, do NOT mark the checkbox.
<b>Allow Free and Reduced Pricing</b>	When this checkbox is marked, students that have an active eligibility record (FRAM > Eligibility) can be given a reduced price for items in the store. The reduced price is set up on the product. If you do not set up a reduced price, the student is charged the regular selling price.

Field	Description
<b>Shop By Categories</b>	<p>This option allows you to set up the School Store for users to shop by category or by products.</p> <ul style="list-style-type: none"> <li>When this checkbox is marked, the first page in the store displays the <a href="#">Categories</a>. Users can select a Category to see the products they can purchase.</li> <li>When this checkbox is <b>not</b> marked, the first page in the School Store displays all of the products in the store. Users still have the option to view and group the products by category from the products page.</li> </ul>
<b>Image Upload</b>	<p>A picture that represents the school store in Campus Student and Campus Parent. If this is your first time uploading an image in Campus, Campus prompts you to accept the Terms and Conditions. Mark the checkbox before you save.</p> <div style="border: 1px solid black; padding: 5px; margin-bottom: 10px;"> <p><b>Consent:</b>  <input checked="" type="checkbox"/> I consent to be bound by the Terms and Conditions of the Acceptable Use Policies of both the District and Infinite Campus.</p> </div> <div style="background-color: #f0d0d0; padding: 10px; border: 1px solid #ccc;"> <p>The image must use one of the following extensions: .jpg, .jpeg, .png, or .gif.</p> </div>

## Create a Public Store

Create a [Public Store](#) by selecting **All Schools** in the Campus toolbar. Use the field descriptions provided here to complete the screen then click **Save**.

**Tip:** See the [Public Store Overview](#) for more information about setting up a Public Store. There are multiple steps that you must complete before products can be purchased on the Public Store.

**Settings** ★  
School Store > Administration > Settings

**Public Store**

ON

**Public Store Home Page**

**Title \***  
Plainview Schools District Store

**Public Store URL**  
https://infinitecampus.com/campus/store/MN

**Require User Account**

**Description**

Format: **B** **I** **U** abc [List Icons]

Thanks for supporting our Student Council and Booster Club by shopping at the School Store!

**Logo Upload**



PlainviewDistrictLogo.png  
Max File Size: 20MB

Select files... Drop files here to upload

**Context**

**Year**  
20-21

**School**  
All Schools

Save Cancel







Save

Example Public Store Settings

## Field Descriptions (Public Store)

Field	Description
-------	-------------

Field	Description
<b>Public Store ON/OFF</b>	<p>Once the Public Store toggle is switched to ON, people can use the Public Store Link found on this Settings page to shop at your Public Store.</p> <div style="background-color: #fff9c4; padding: 10px; border: 1px solid #ccc;"> <p>You must fill in the Public Store Home Page section before the Public Store toggle can be switched to ON.</p> </div>
<b>Public Store Home Page</b>	
<b>Title</b>	The name of the store as it appears in Campus Student and Campus Parent.
<b>Public Store URL</b>	This is the link people can use to shop at your Public Store. The URL is cannot be modified.
<b>Require User Account</b>	<p>Public Store customers can create a user account before they make purchases on the Public Store. If you mark this checkbox, customers will be <b>required</b> to create a user account before making a purchase.</p> <p>When someone creates an account, their name and email address are saved in Campus in the Demographics tool and Campus assigns the <i>Public Store</i> Homepage to their <a href="#">user account</a>. Public Store customers can review their payment methods and purchase history after they log in.</p> <p>▶ <a href="#">Click here to expand...</a></p>

Field	Description						
<p><b>Description</b></p>	<p>The text you enter in this field displays below the Title on the Public Store.</p> <div data-bbox="475 349 1414 1072" style="border: 1px solid black; padding: 10px;"> <p><b>Plainview Schools District Store</b></p> <div style="border: 2px solid red; padding: 5px; margin-bottom: 10px;"> <p>Thanks for supporting our Student Council and Booster Club by shopping at the School Store!</p> </div> <table border="0" style="width: 100%;"> <tr> <td style="width: 50%; text-align: center; padding-bottom: 5px;"> <p>Arthur Elementary Sch...</p> </td> <td style="width: 50%; text-align: center; padding-bottom: 5px;"> <p>Carter Middle School ...</p> </td> </tr> <tr> <td style="text-align: center;">  </td> <td style="text-align: center;">  </td> </tr> <tr> <td style="text-align: center;"> <input type="button" value="Store"/> </td> <td style="text-align: center;"> <input type="button" value="Store"/> </td> </tr> </table> </div>	<p>Arthur Elementary Sch...</p>	<p>Carter Middle School ...</p>			<input type="button" value="Store"/>	<input type="button" value="Store"/>
<p>Arthur Elementary Sch...</p>	<p>Carter Middle School ...</p>						
							
<input type="button" value="Store"/>	<input type="button" value="Store"/>						

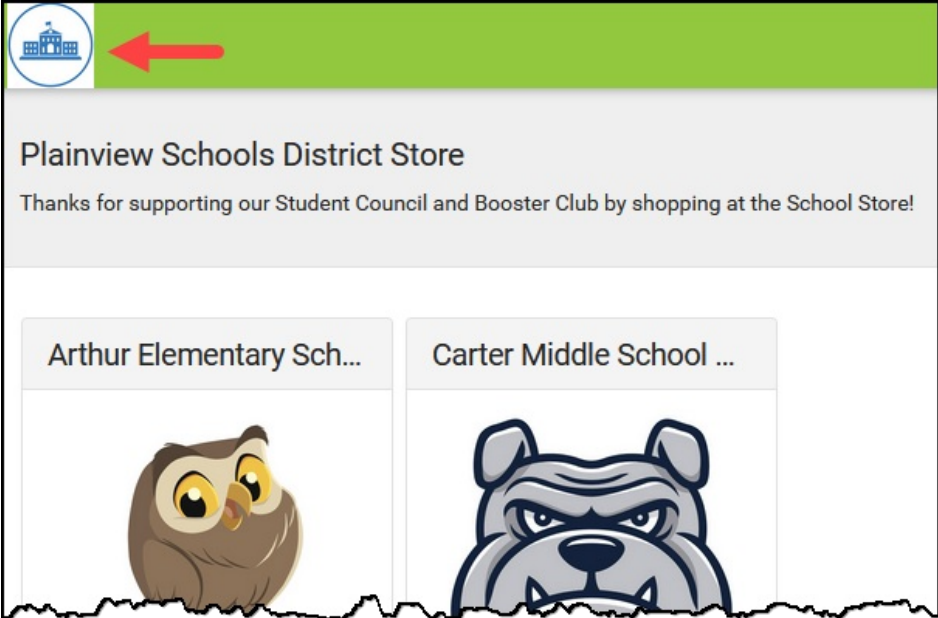
Field	Description
<p><b>Logo Upload</b></p>	<p>A picture that represents the Public Store. This image displays at top of the page.</p> <p>The image must use one of the following extensions: .jpg, .jpeg, .png, or .gif.</p>  <p>The screenshot shows a school store interface. At the top left, there is a circular logo placeholder with a red arrow pointing to it. Below the logo is a header for "Plainview Schools District Store" with a thank-you message. The main content area features two school logos: "Arthur Elementary Sch..." with an owl mascot and "Carter Middle School ..." with a bulldog mascot.</p> <p>If this is your first time uploading an image in Campus, Campus prompts you to accept the Terms and Conditions. Mark the checkbox before you save.</p> <p>Consent:  <input checked="" type="checkbox"/> I consent to be bound by the Terms and Conditions of the Acceptable Use Policies of both the District and Infinite Campus.</p>